

XT-8315/XT-8315E

Specification		XT-8315	XT-8315E
Processor	Intel Tiger Lake UP3 Core i3 Intel Tiger Lake UP3 Core i5 Intel Tiger Lake UP3 Core i7		
System Memory	DDR4 SO-DIMM x 2, max. 64 GB		
Storage Device	M.2 connector [Support both SATAIII signal and PCIe signal] x 2		
RAID Function	Yes		
Intel vPro Support	Yes, depend on processor		
TPM Support	Yes, TPM 2.0		
Power Supply	12V/60W	12/150W	
OS Support	Windows 10 IoT LTSC / Windows 11 IoT LTSC		
Display & Touch			
LCD	15" TFT LCD		
Resolution	1024 x 768		
Touch	True-flat PCAP touch with multi-touch support (IP65 on front panel)		
I/O & Expansion			
Serial Port	5, RJ50 x 3 + 2 via optional converter cable from service window, 5V support on all COM ports, 12V support on COM1 to 3 (all converter cables are optional)		
Parallel Port	1, via optional conversion cable through service window		
Standard USB Port	6, USB 3.0 x 4 + USB 2.0 x 2	7, USB 3.0 x 4 + USB 2.0 x 2 + USB Type-C x 1 (for both storage & display)	
PoweredUSB Port	Optional 24V x 1 + 12V x 3 via GEN8E base	24V x 1; Optional 24V x 1 + 12V x 3 via GEN8	
LAN Port	10/100/1000 Mb x 2		
Display Port	2, VGA x 1, 12V support for Posiflex monitors + HDMI x 1		
CR Port	1, control 2 CR via optional Y-cable, supporting 24V cash drawer		
PS/2 Port	1, via optional conversion cable through service window		
UPS Port	Yes, battery optional		
Audio	Internal 2W speaker x 1 + Line-out/mic-in combo jack		
Expansion Slot	M.2 slot x 1		
Physical Dimension			
Dimensions (W x D x H in mm)	372 x 252.7 x 320		
Weight (N. W. in kg)	6		
Environmental			
Operating Condition	0°C - 40°C, 20%RH - 90%RH		
Storage Condition	-20°C - 70°C, 10%RH - 90%RH		
Built-in Options			
WiFi	M.2 WiFi/BT module		
Attachment Options			
POS Monitor	Non-touch TFT LCD: 7"/9.7"/12.1"/14"/15"; PCAP touch TFT LCD: 9.7"/14"/15"; Resistive touch TFT LCD: 15"		
Line Display	2 x 20 rear-mount VFD/LCD customer line display; 7" color LCD graphical customer line display		
Attachment	MSR; iButton; Rotatable 2D Scanner; RFID; Fingerprint Sensor; Keypad		

*Designed and Manufactured in Taiwan by Posiflex Technology, Inc.
*Please refer to the website for more attachment options.
*The product information and specifications are subject to change without prior notice.
*Product specifications and model configurations are subject to change and may vary by global region.

Certifications	FCCESGSUKASRoHSREACHWindows Embedded Partner	EN20240314V1
----------------	--	--------------



POSIFLEX TECHNOLOGY, INC.

No. 23, Datong St., Tucheng Dist., New Taipei City 23679, Taiwan
Tel : +886-2-2268-5577 E-mail : sales@posiflex.com.tw
Fax : +886-2-2268-5388 www.posiflex.com

Authorized Distributor / Reseller



Power and Style
for Your Business

XT-8315/XT-8315E

High-End Fanless POS Terminal

XT-8315/XT-8315E

POSIFLEX



The XT-8315/ XT-8315E

is the companion of the XT-8315/ XT-8315E which have been enhanced with 11th Gen Intel® Tiger Lake CPUs, which are powerful enough to handle any task imaginable that comes its way.

Sleek Look

The XT-8315/ XT-8315E come from new Posiflex design language. Slimmer than ever, They are sharp departure from the traditionally conservative Posiflex terminal design. Every curve and detail of the XT-8315/ XT-8315E is carefully thought out to make itself one of the most visually desirable terminals in the market.

Superior Performance

Equipped with high-end CPU selection up to Intel Core i7, the XT-8315/ XT-8315E are able to deliver robust performance to process anything you throw at them without even breaking a sweat.

Multi-Position Folding Base (U.S. Patent 9004436)

The XT-8315/ XT-8315E provide the selection of two foldable bases, the curvy slim GEN7E base and the larger but practical GEN8E base. The foldable base can be configured into "Flat Folded Mode" to save the shipping package volume, "Low Profile Mode" to allow greater interaction between the cashier and the customer, and the traditional "Full Extended Mode". All this can be achieved with a simple pull of the hidden lever.



Full Extended Mode



Low Profile Mode



Flat Folded Mode

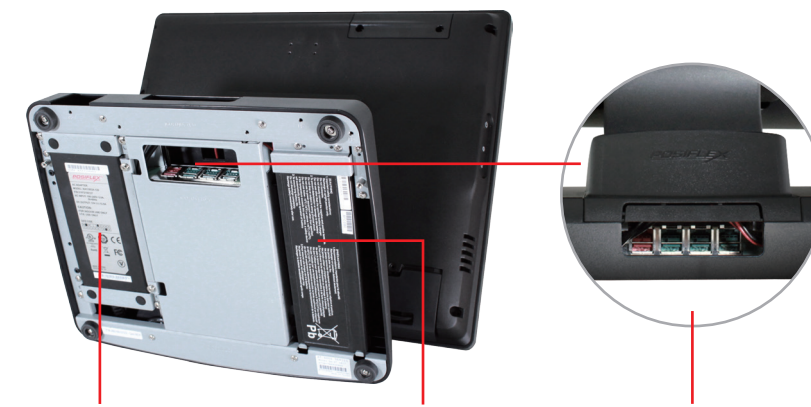

Power Adaptor

UPS Battery

PoweredUSB Ports

Patented Fanless Technology

Solve the fan maintenance issue and provide silent mode operation, which is ideally suited for high-end boutique stores or hospital environments.

GEN8E Base (U.S. Patent 9004436)

Optional GEN8E base integrates internal power adaptor and PoweredUSB port into the base stand, which keeps counters clutter-free.